

Pepper Daily Use and Maintenance

Every robot has a certain lifespan, and the Pepper robot is no exception. If you don't take proper care of it during use, it may shorten the lifespan of your Pepper robot. If you don't take care of your Pepper robot properly, it may shorten its life span, affect its performance, or even cause hardware damage. Below is a description of how to use and maintain Pepper in daily work.

Daily use

1. Work Environment Inspections

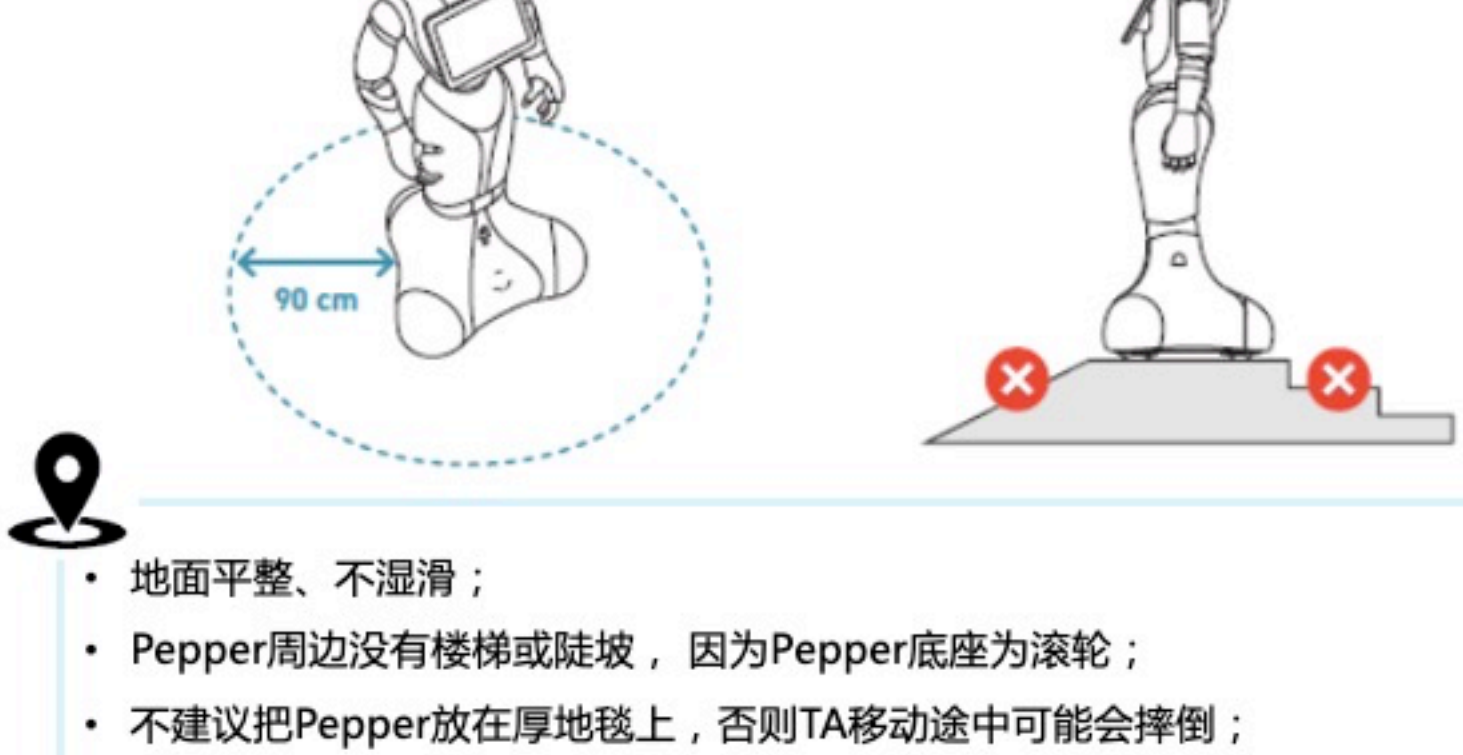

- 地面平整、不湿滑；
- Pepper周边没有楼梯或陡坡，因为Pepper底座为滚轮；
- 不建议把Pepper放在厚地毯上，否则TA移动途中可能会摔倒；
- 建议Pepper四周至少有90cm的自由活动空间。

Pepper应处于安静的环境中，以提高语音识别率。



请避免强光直射 Pepper脸部。



Pepper应被放置在室内，请避免户外环境。



请避免2m高以内的直立物体在Pepper面前，以免出现误识别。



2. Robotics Overview

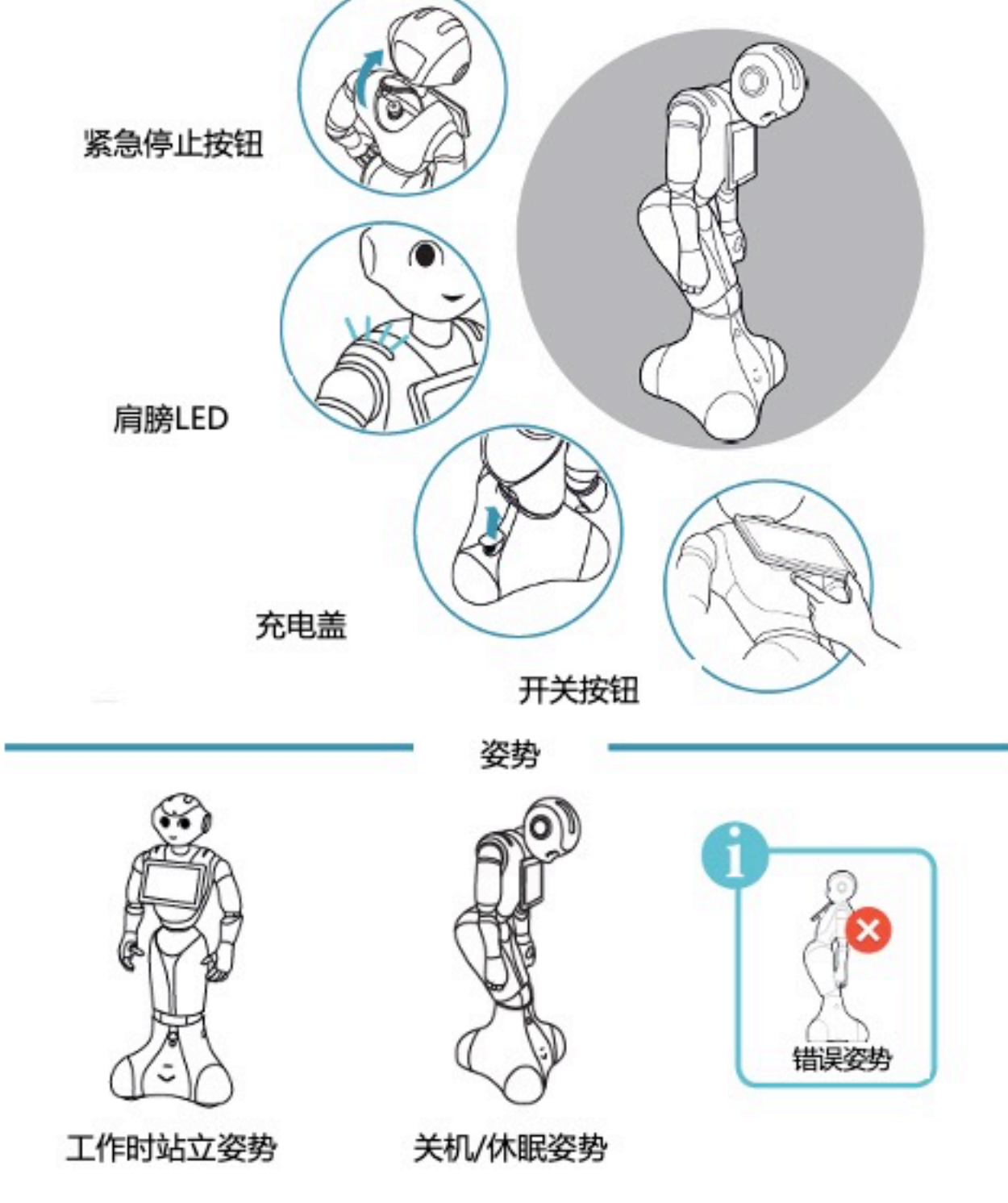

3. Charging

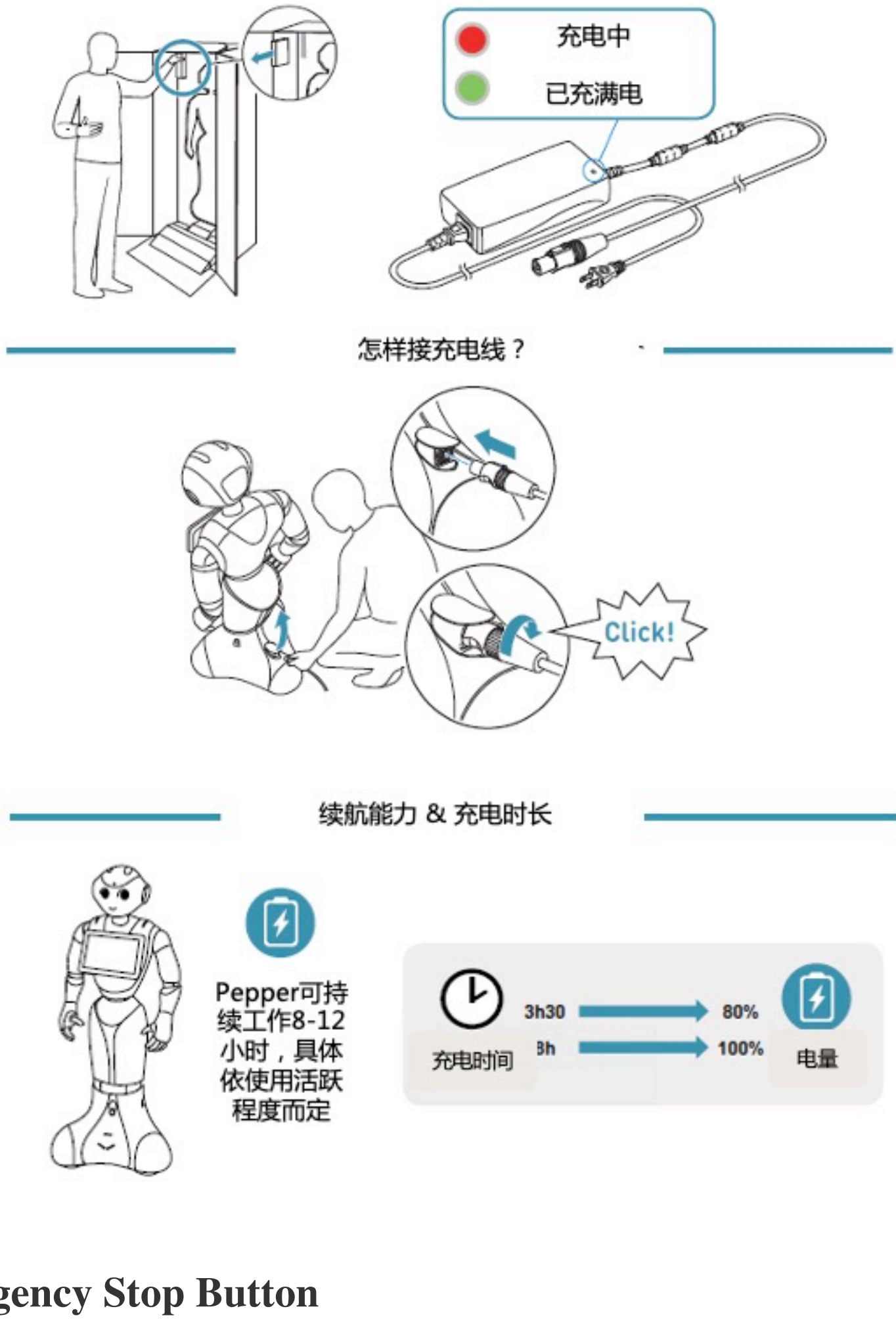

4. Emergency Stop Button

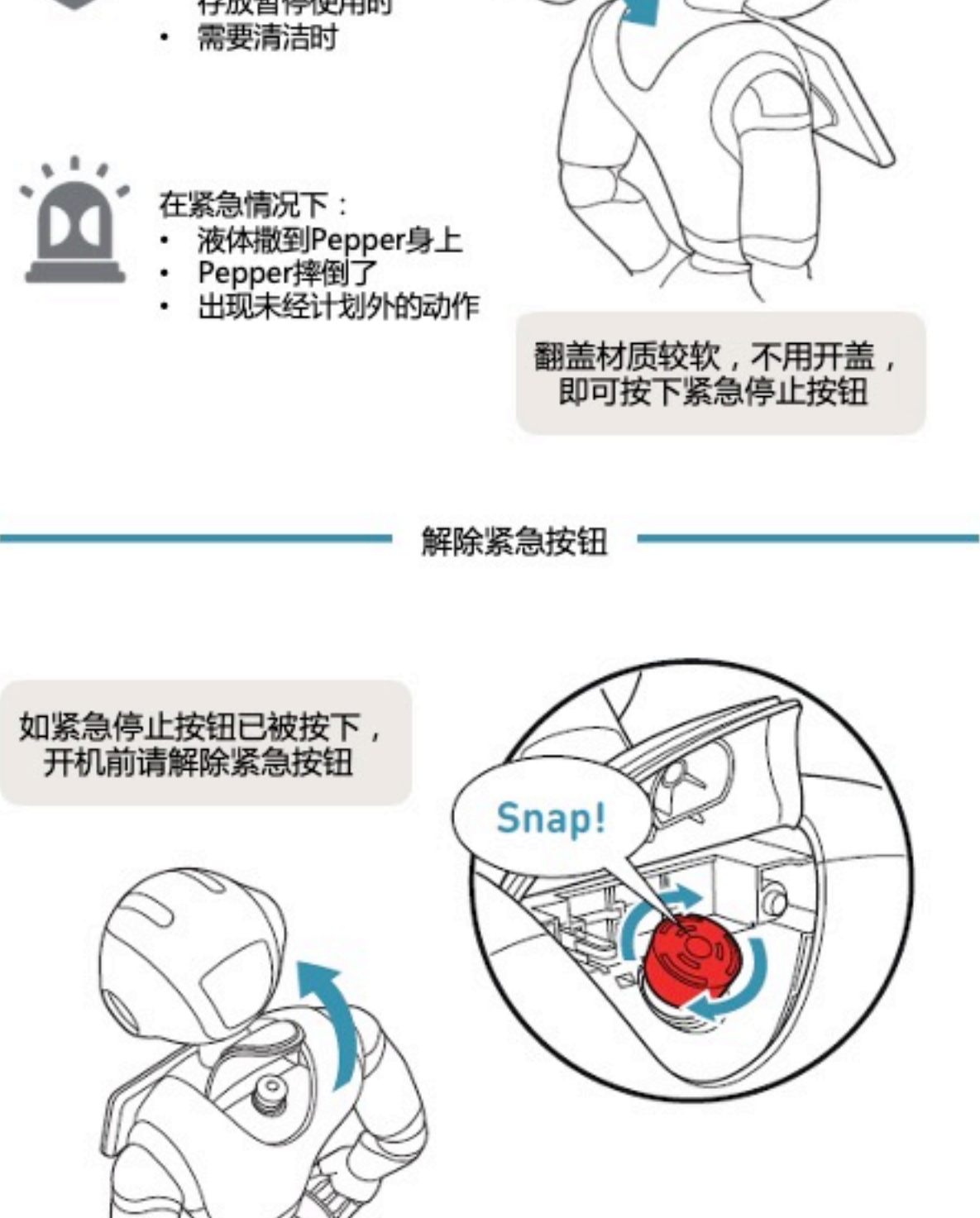

5. Switching Robots

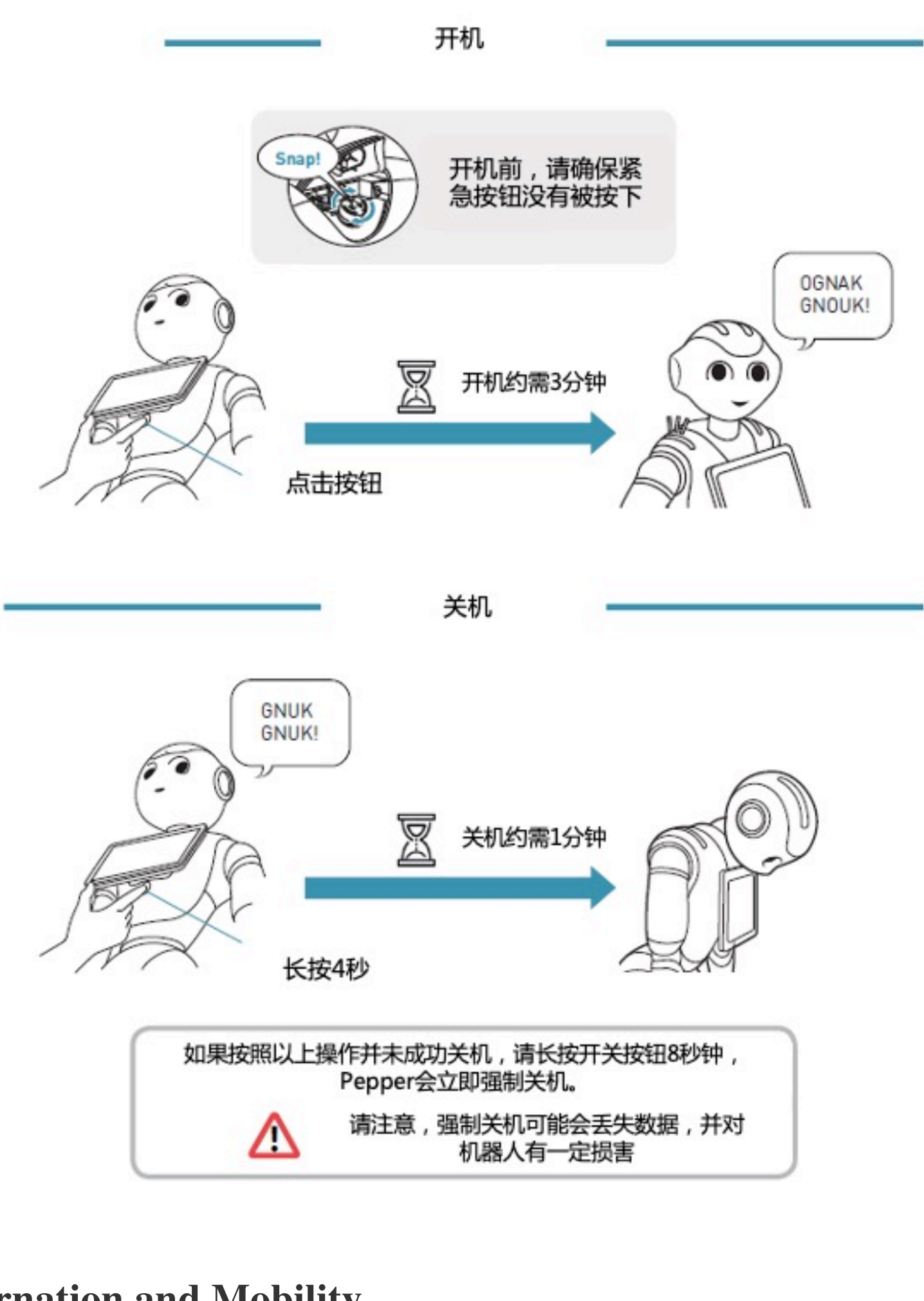

6. Hibernation and Mobility

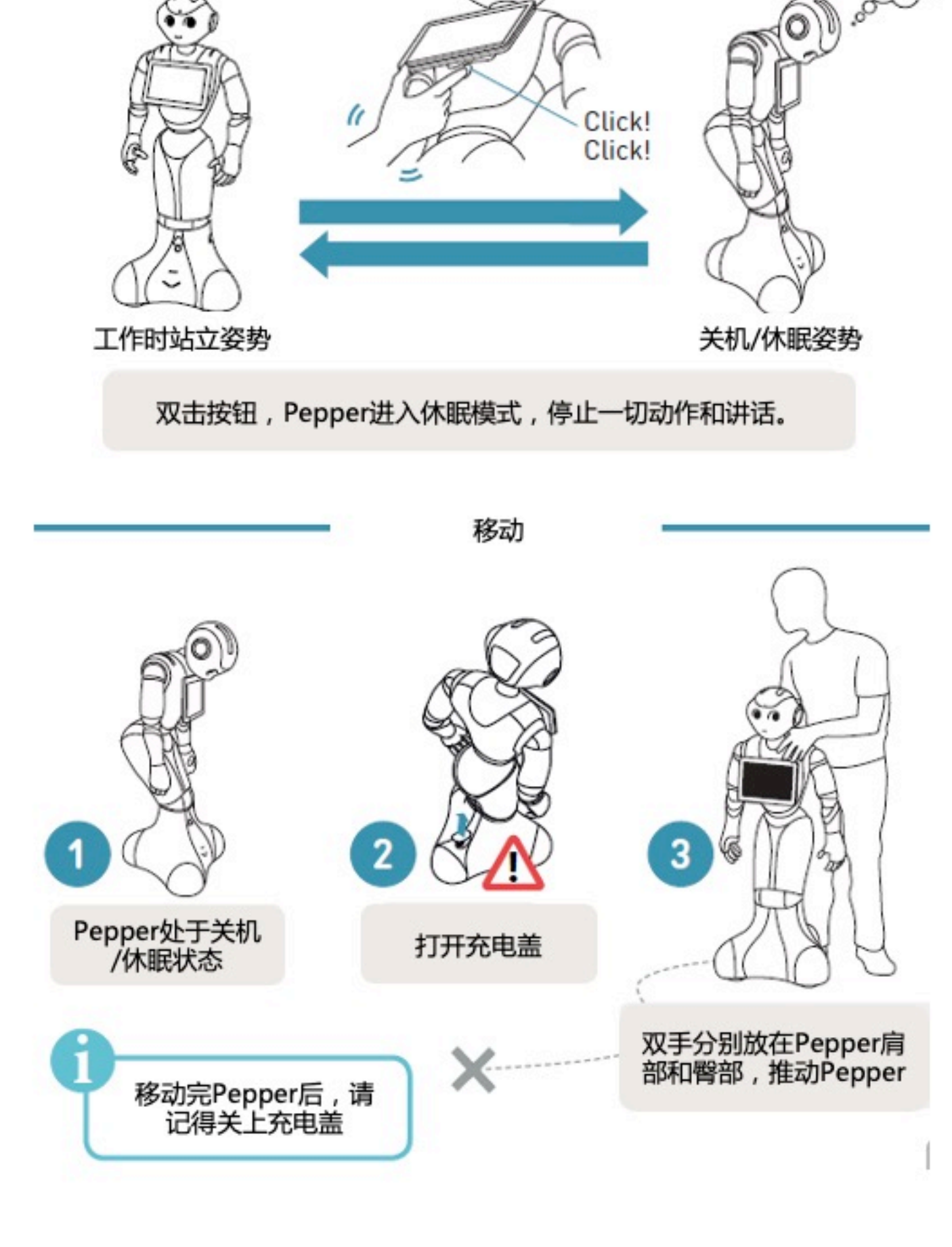

7. Fault Resolution

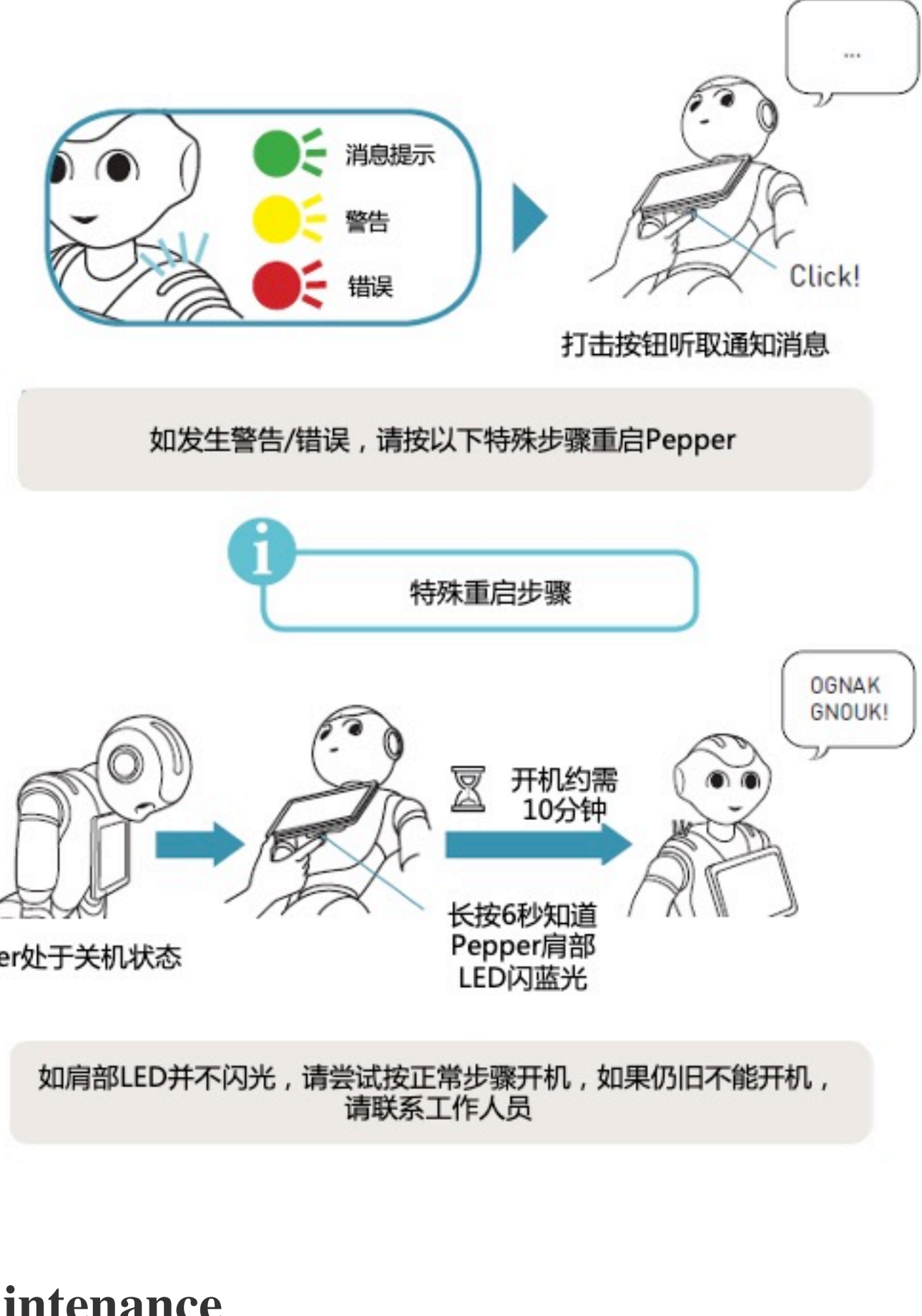

Daily Maintenance

